

SURESIP is strong, durable and easy to install. Specifically designed to provide a cost effective, lightweight roof and wall solution for protection and insulation of many buildings.

SURESIP consists of two 11mm OSB-3 face's and options of 50-150mm rigid polyurethane foam core with a mean density of 40kg/m³. At 125mm the U-Value is .17W/m².k compliant part L 2019 building regulation.

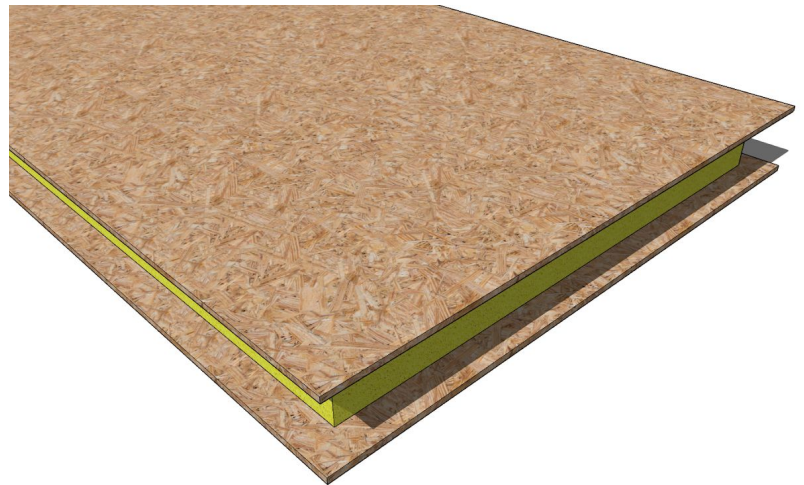

SURESIP benefits include:

- Quick and easy installation.
- Cost effective roof and wall solution.
- Excellent Load-Bearing.
- FSC certification.
- CE marked.
- Structural.
- Sustainable.
- Stock Lengths : 2.44,3m (8 & 10 foot)

PUR (CORE) thickness (mm)	U-value SIP (W/m ² .K)
50	0.40
75	0.28
100	0.21
125	0.17
150	0.14

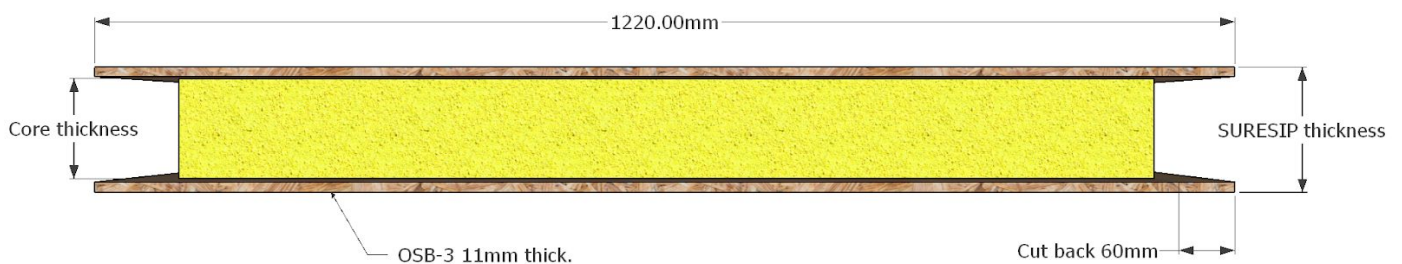

PUR (CORE) thickness (mm)	SURESIP thickness (mm)	Span type (mm)	Span length (mm)	Service load at L/360 deflection (kN·m ⁻²)	Service load at L/250 deflection (kN·m ⁻²)	Service load at L/180 deflection (kN·m ⁻²)
50	72	Single	2320	1.50	2.15	3.00
75	97	Single	2350	2.53	3.65	5.05
100	122	Single	2320	3.65	5.25	7.30
125	147	Single	2320	4.80	6.95	9.65
150	172	Single	2320	6.00	8.70	12.10
50	72	Single	2880	0.97	1.40	1.95
75	97	Single	2880	1.70	2.42	3.37
100	122	Single	2880	2.50	3.60	5.00
125	147	Single	2880	3.35	4.85	6.70
150	172	Single	2880	4.25	6.15	8.50