

External SURESIP

External SURESIP is strong, durable and easy to install. Specifically designed to provide a cost effective, lightweight floor and wall solution for protection and insulation of many buildings. Due to the fact the external face is waterproof and durable no additional protection such as breathable membranes or external cladding is required. Significantly reducing build time and cost.

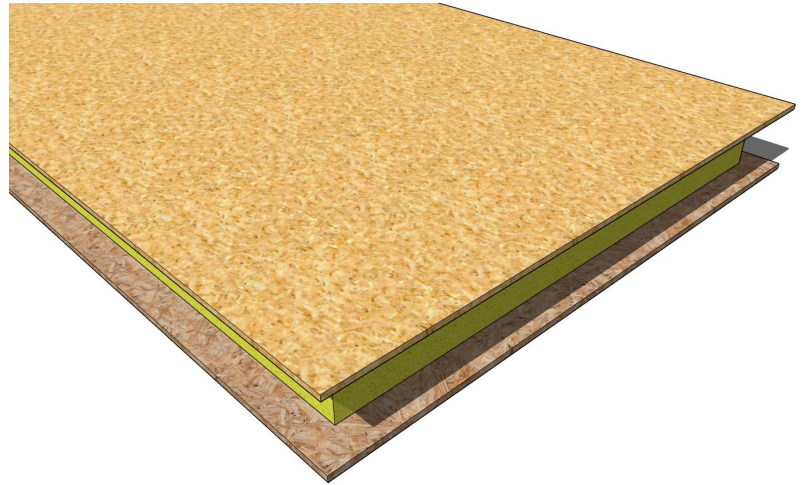

External SURESIP consists of an 11mm OSB-3 internal face and a waterproof 9mm external face with 125 mm rigid polyurethane foam core with a mean density of 40kg/m³. At 125mm the U-Value is .17W/m².k compliant part L 2019 building regulation. Use the 152mm External SURESIP when considering floor applications.

SURESIP benefits include:

- Quick and easy installation.
- Waterproof.
- Excellent Load-Bearing.
- FSC certification.
- CE marked.
- Structural.
- Sustainable.
- Stock Lengths : 2.44m (8 Foot)
- Durable.
- 50 year warranty.
- Resistant to Fungal decay.

PUR (CORE) thickness (mm)	U-value SIP (W/m ² .K)
125	0.17

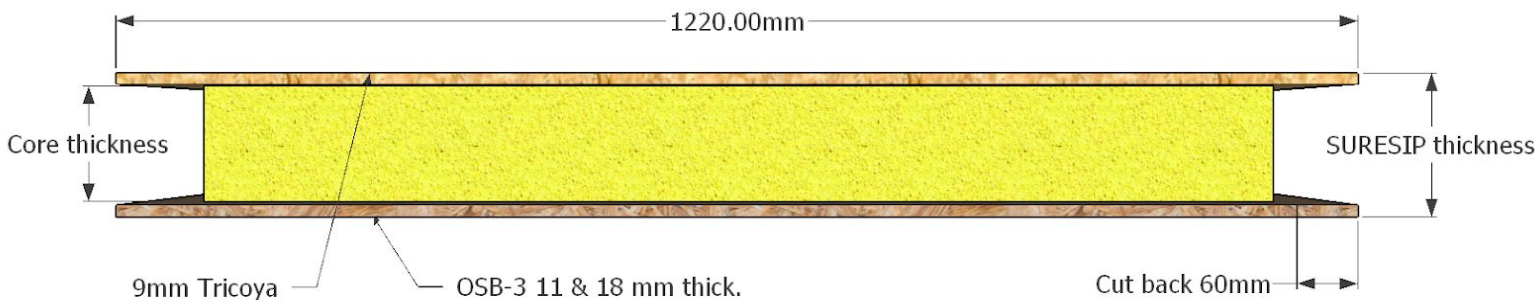

PUR (CORE) thickness (mm)	SURESIP thickness (mm)	Span type (mm)	Span length (mm)	Service load at L/360 deflection (kN·m ⁻²)	Service load at L/250 deflection (kN·m ⁻²)	Service load at L/180 deflection (kN·m ⁻²)
125	145	Single	2320	4.50	6.55	9.05
125	152	Single	2320	4.70	6.70	9.35